

Harmonic Balancer/Underdrive Pulley, 2005-2007 5.7L/6.1L Dodge Magnum/Charger/300C/2009 6.1L Challenger

PACKING LIST

Before installation, use this check list to make sure all necessary parts have been included.

ITEM	QTY	CHECK	PART NUMBER	DESCRIPTION
1.	1	<input type="checkbox"/>	100630105	Underdrive Pulley, Crankshaft, 25%, 2005-2007 5.7/6.1 Dodge
2.	1	<input type="checkbox"/>	*****	Instructions

WARNING: SLP Recommends wearing safety glasses for the complete installation.

WARNING: SLP Recommends allowing the vehicle to cool (not running) for five hours before beginning installation.

WARNING: Too avoid the chance of electrical shock or damage to your vehicle's electrical system, disconnect both the negative and positive batter leads (in that order) at the battery.

REMOVAL/INSTALLATIONINSTRUCTIONS – #100235

REMOVAL

1. Disconnect negative cable from battery.
2. Remove accessory drive belt
3. Drain cooling system
4. Remove radiator upper hose.
5. Remove fan shroud
6. Remove crankshaft damper bolt.
7. Remove damper using Special Tools 8513A Insert and 1023 Three Jaw Puller.

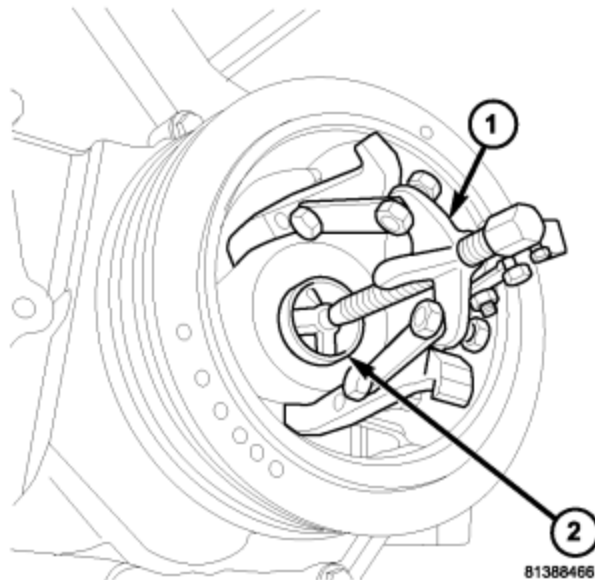

INSTALLATION

CAUTION: To prevent severe damage to the Crankshaft, Damper or Special Tool 8512-A, thoroughly clean the damper bore and the crankshaft nose before installing Damper.

4/14/08

1. Slide damper onto crankshaft slightly.

CAUTION: Special Tool 8512–A, is assembled in a specific sequence. Failure to assemble this tool in this sequence can result in tool failure and severe damage to either the tool or the crankshaft.

2. Assemble Special Tool 8512–A as follows, The nut is threaded onto the shaft first (2). Then the roller bearing (1) is placed onto the threaded rod (3) The hardened bearing surface of the bearing (1) **MUST** face the nut (2). Then the hardened washer (5) slides onto the threaded rod (3) . Once assembled coat the threaded rod's threads with Mopar® Nickel Anti-Seize or (Loctite No. 771).
3. Using Special Tool 8512–A, press damper onto crankshaft.
4. Install then tighten crankshaft damper bolt to 176 N·m (129 ft. lbs.).
5. Install radiator upper hose.
6. Install accessory drive belt
7. Refill cooling system
8. Connect negative cable to battery.

